

# 99078

## Dimensions

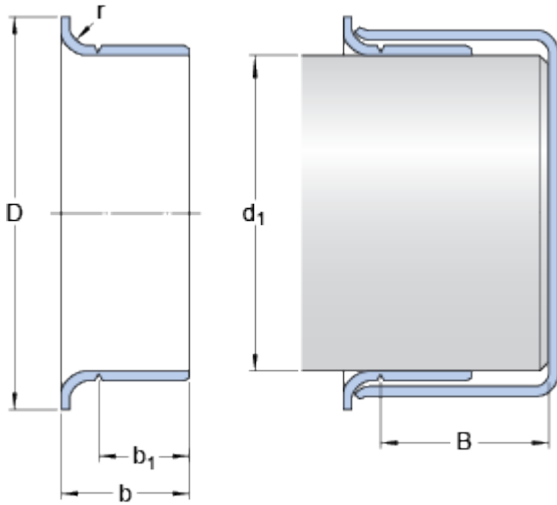

### Nominal dimensions

$d_1$		20	mm
$D$		23.622	mm
Tolerance outside diameter $D$	$\pm$	1.6	mm
$b$		10.998	mm
Tolerance width $b$	$\pm$	0.8	mm
$b_1$		8.001	mm
Tolerance width $b_1$	$\pm$	0.8	mm
$B$	max.	50.8	mm
$r$	max.	3.18	mm

### Shaft diameter range

$d_1$	min.	19.939	mm
$d_1$	max.	20.041	mm